



# SERVICE BULLETIN

Classification: RA17-004	Reference: NTB17-107	Date: September 26, 2017
-----------------------------	-------------------------	-----------------------------

## 2016-2017 MAXIMA AND ALTIMA; POP/CLUNK NOISE FROM REAR WHEN DRIVING OVER BUMPS

**APPLIED VEHICLES:** 2016 – 2017 Altima (L33) **SR Only**  
2016 – 2017 Maxima (A36)

**APPLIED VIN // DATE:** 2016 Maxima and Altima; All VINs and Dates

2017 Altima built before:

1N4(\*)L3AP(\*)HN 359754 // May 16, 2017

1N4(\*)L3AP(\*)HC 265139 // May 16, 2017

2017 Maxima built before:

1N4AA6AP(\*)HC 431432 // May 16, 2017

### IF YOU CONFIRM

A pop or clunk noise from the rear of the vehicle, especially when driving over bumps,

### AND

The rear suspension connecting rod nuts are found to be loose on the left and/or right side.

### ACTION

Replace the connecting rod and nuts on the left and/or right side with the ones listed in Parts Information.

**IMPORTANT:** The purpose of ACTION (above) is to give you a quick idea of the work you will be performing. You **MUST** closely follow the entire SERVICE PROCEDURE as it contains information that is essential to successfully completing this repair.

Nissan Bulletins are intended for use by qualified technicians, not 'do-it-yourselfers'. Qualified technicians are properly trained individuals who have the equipment, tools, safety instruction, and know-how to do a job properly and safely. NOTE: If you believe that a described condition may apply to a particular vehicle, DO NOT assume that it does. See your Nissan dealer to determine if this applies to your vehicle.

## SERVICE PROCEDURE

1. Remove the connecting rod nuts on the affected side.
2. Remove the connecting rod.
3. Install the new connecting rod and nuts.
  - New connecting rods and nuts are listed in the Parts Information.

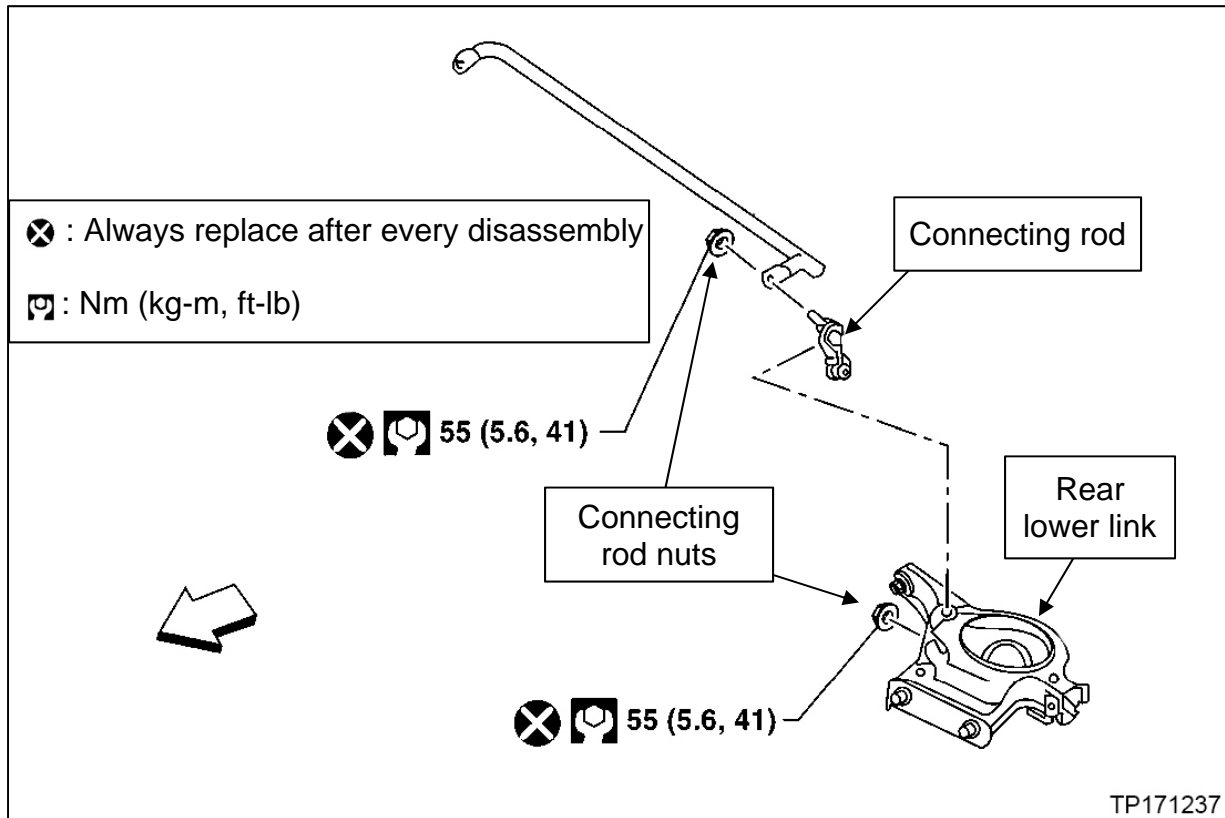

Figure 1

## PARTS INFORMATION

DESCRIPTION	PART NUMBER	QUANTITY (PER SIDE AS NEEDED)
ROD-CONN,STAB RH	56261 - 3TA0C	1
ROD-CONN,STAB LH	56261 - 3TA0D	1
CONNECTING ROD NUTS	01225 – N0031	2

## CLAIMS INFORMATION

Submit a Primary Part (PP) type line claim using the following claims coding:

DESCRIPTION	PPF	OP CODE	SYM	DIA	FRT
Replace Connecting Rod (1 Side)	(1)	NH62AA	ZL	32	(2)
Replace Connecting Rod (Both Sides)		NH63AA			

- (1) Reference the Parts Information table above, and use 56261-XXXXX as the Primary Failed Part (PPF).
- (2) Reference the current Nissan Warranty Flat Rate Manual and use the indicated Flat Rate Time (FRT).

